

SolarHome 620

Multi-Room Solar Light & Power

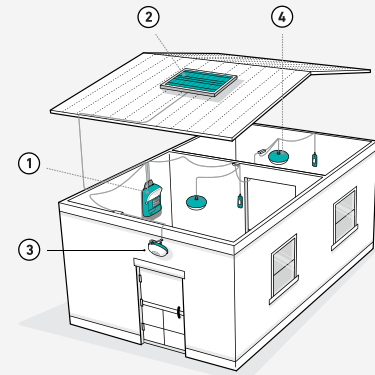

- 1 Control box with radio, mp3 player, light and USB power out
- 2 6 watt solar panel
- 3 Motion sensor security light
- 4 Ceiling mounted lights

Born out of household research across India and sub-Saharan Africa, the SolarHome 620 is a self-contained system of solar lighting and charging that can turn any off-grid structure into an electrified home. The system combines functional and protective lighting (motion sensor included), USB charging, and radio and mp3 capabilities, creating a hub designed for everyday use.

Ideal for cabins, van life, and hunting structures, the SolarHome 620 is a perfect entry into solar living with easy installation and flexible setup.



6 Watt Solar System

Generate from the sun and store inside 20 watt-hour powerbank located in control box



Multi-Room Overhead Light

Illuminate multiple spaces with (2) 100 lumen string lights, each with individual ON/OFF switch



MP3 & Radio Capability

Access your music with on-board speaker



Motion Sensor Light

3rd light comes with motion sensor capabilities for basic security



Centralized Control Box

Easy to use digital display for real-time feedback on power availability, speaker control, and device charging

Tech Specs

DIMENSIONS

Control Box:
7.9 x 6.0 x 2.7 in
(200 x 154 x 68 mm)

Hanging Lights (each)
5.9 x 5.5 x 3.2 in
(150 x 140 x 82 mm)

CORD LENGTH

Solar Panel: 18 ft (5.5 m);
Lights: 21 ft (6.5 m)

OUTPUTS

USB charge out x2
DIN port x1
Light Port x2
Light Junctions x3

INPUTS

Solar Panel Port x1

LUMENS

100 Lm per light

IN THE BOX

Control Unit, 2 Hanging
Lights, 1 Security Light,
1 Solar Panel

BATTERY

6.4V - 3300 mAh (20 Whr)

WATER RESISTANCE

Splash resistant

WEIGHT

Control Box:
1.21 lbs (550 g)

Hanging Lights (each):
0.66 lbs (300 g)

Solar Panel
1.59 lbs (720 g)

SOLAR PANEL

6 watts

RUN TIME

With all 4 lights on, 1 day
of full sun provides:

14 hours (LO brightness)
7 hours (MED brightness)
4.5 hours (HI brightness)

DIMMABLE

Dim hanging lights via
mounted switch